

SDI | RIVA STAR

INSTRUCTIONS



DESENSITISING CERVICAL TOOTH HYPERSENSITIVITY



Clean teeth with prophylactic paste and isolate area with cotton rolls.

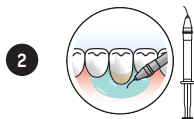

Dry area and apply a small amount of Gingival Barrier to adjacent tissue. Protect lips with petroleum jelly/cocoa butter.

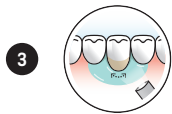

Light cure in a fanning motion.

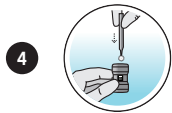

Using silver brush, pierce foil on silver capsule. In circular motion, push foil to the edge of the opening.

SDI | RIVA STAR

5



Carefully apply solution from silver capsule to treatment site only.

6



Immediately using green brush, pierce foil on green capsule. In circular motion, push foil to the edge of the opening.

7



Apply generous amount of solution from green capsule to treatment site. Keep applying until creamy white turns clear.

8



Blot dry, remove gingival barrier.

INSTRUCTIONS



CAUTION

The material could stain teeth if incorrectly used.
Patient must be informed of this risk prior to its use.